

Products > Balls & Hemispheres > Drilled Balls > DB1.00

Drilled Balls - DB1.00

Specifications

Model	DB1.00
Diameter	.0393"
Inside Diameter	.020/.022"
Grade	10
ID Length	.020"
Type	blind hole



Description

We can supply any of our precision drilled balls with drilled holes, which provides an excellent way to mount the drilled ball in an instrument. ID tolerances down to .0008" drilled entirely through the ball or depth controlled. While we list two sizes, we have many different combinations of drilled balls available for quick delivery in Sapphire, Ruby, Ceramic and Silicon Nitride materials.

Typical Applications

- Metrology Measuring Tips
- Probe Tips
- Master Ball Gauge
- Pump Check Valves

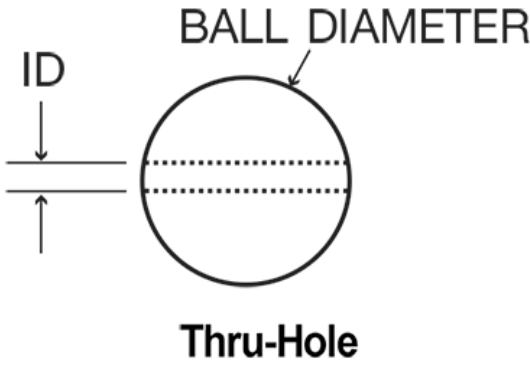
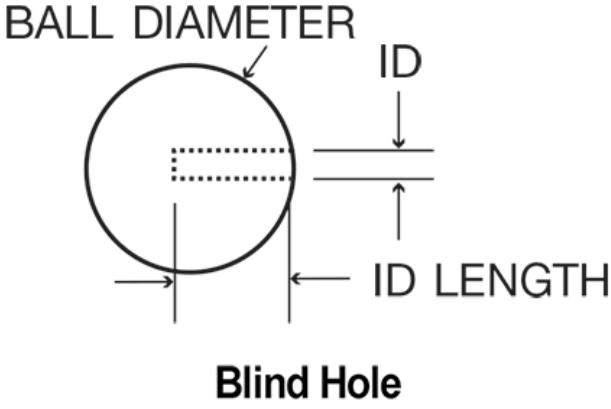
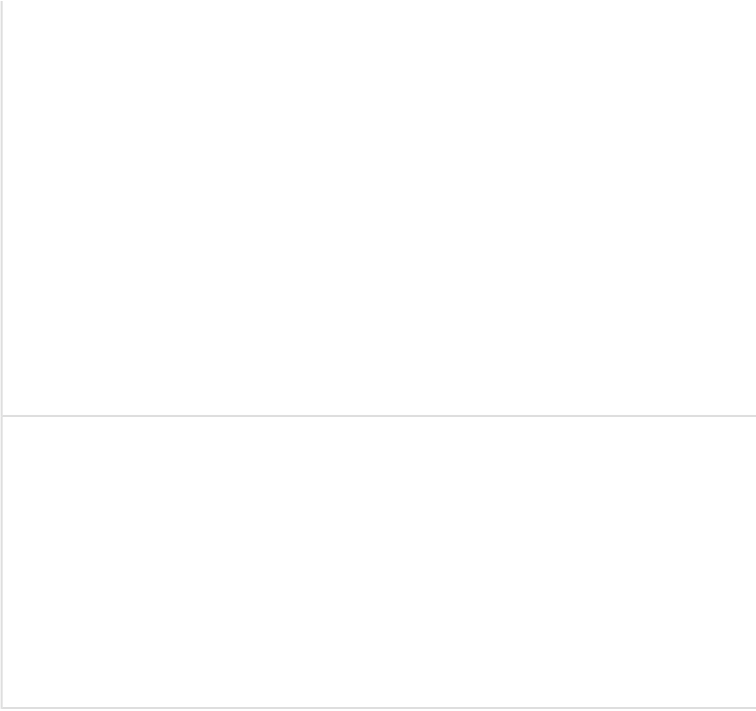

NOT SEEING EXACTLY WHAT YOU NEED?

We specialize in creating a wide range of custom optical components and custom mechanical components including a variety of shapes - from internal holes and tapers to outer flanges, angles and surface finishes. Contact us and we will consult with you to create a custom component that meets all of your specifications.