

Products > Sapphire Stylus > SP-79

# Sapphire Stylus - SP-79

## Specifications

<b>Model</b>	SP-79
<b>Outside Diameter</b>	.0195/.0205"
<b>Length</b>	.050"
<b>Radius</b>	.0025/.0030"
<b>Type</b>	sapphire stylus

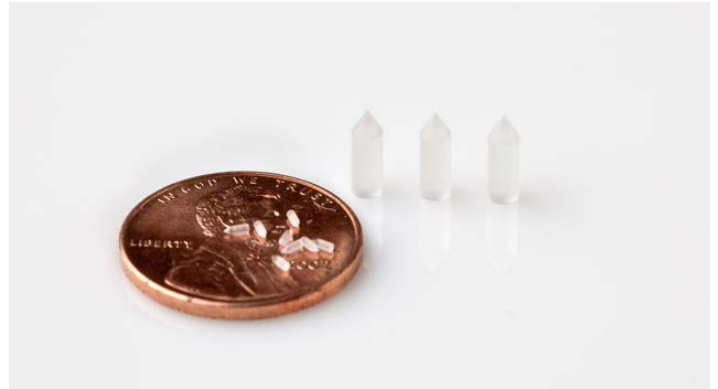

### Description

A sapphire stylus is a small pin-point component where the end radius is controlled to as small as .001". Sapphire's hardness and ability to accept a good polish provide for a very hard and smooth tip which provide an excellent point of contact, perfect for a stylus.

### Typical Applications

- Recording Instruments
- Accelerometers
- Vibration Sensors

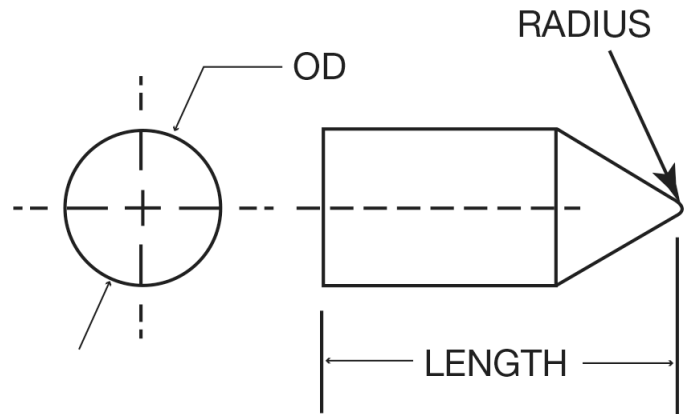

### NOT SEEING EXACTLY WHAT YOU NEED?

We specialize in creating a wide range of custom optical components and custom mechanical components including a variety of shapes - from internal holes and tapers to outer flanges, angles and surface finishes. Contact us and we will consult with you to create a custom component that meets all of your specifications.