

Products > Sapphire Stylus > SP-80

Sapphire Stylus - SP-80

Specifications

Model	SP-80
Outside Diameter	.020/.022"
Length	.058/.062"
Radius	.0010/.0015"
Type	sapphire stylus

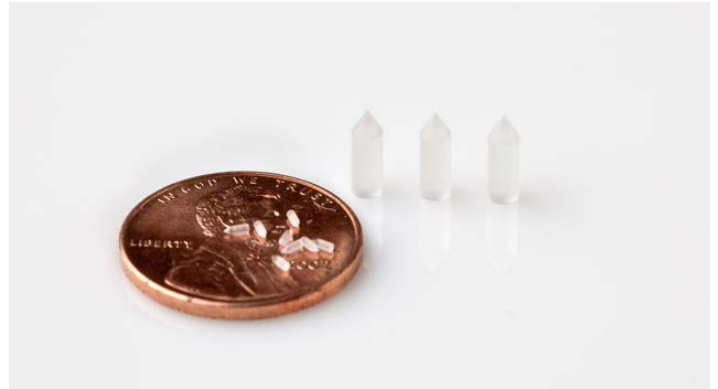

Description

A sapphire stylus is a small pin-point component where the end radius is controlled to as small as .001". Sapphire's hardness and ability to accept a good polish provide for a very hard and smooth tip which provide an excellent point of contact, perfect for a stylus.

Typical Applications

- Recording Instruments
- Accelerometers
- Vibration Sensors

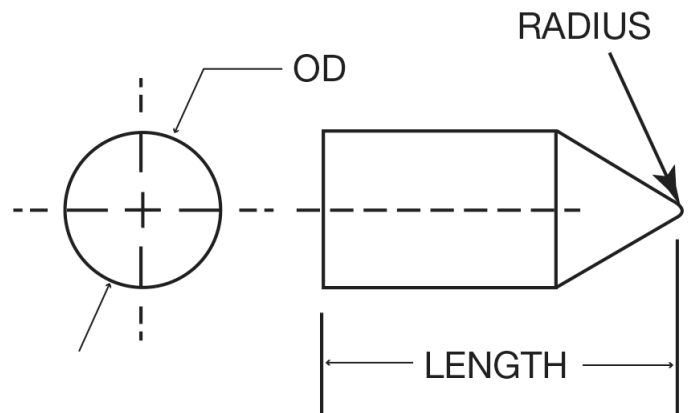

NOT SEEING EXACTLY WHAT YOU NEED?

We specialize in creating a wide range of custom optical components and custom mechanical components including a variety of shapes - from internal holes and tapers to outer flanges, angles and surface finishes. Contact us and we will consult with you to create a custom component that meets all of your specifications.